

TECHNICAL FEATURES :  
 Max speed : 6000 rpm  
 Max torque : 50Nm  
 Ratio : 1:0.81  
 Output : ER32

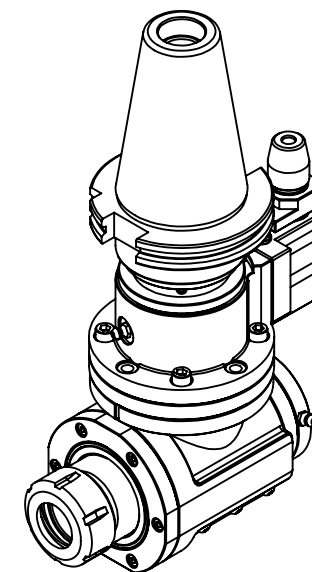

Machine type :

SK50



豪力輝工業股份有限公司  
 HOLD WELL INDUSTRIAL CO.,LTD

E-mail : sales@mail.holdwell.com  
<http://www.holdwell.com>

品號

Model No.

AHA-SK50-ER32.80

品名

Description

A型 SK50-ER32  
 90度橫向銑頭(中心距80)